

**Data**

Part No.	Code No.	for End
107 332 02 20	0702	lefthand
107 332 03 20	0703	righthand

**Tightening Torques**

	Nm	(kpm)
Hex. screw for attaching steering knuckle arm to steering knuckle	80	(8)
Hex. nut for attaching track rod to steering knuckle arm	35	(3.5)

**Special Tool**

Puller for track rod	136 589 12 33 00
----------------------	------------------

**Conventional Tool**

Open double box wrench 10 x 11 for brake lines

e.g. made by Hazet/Remscheid  
Order No. 612

**Removal**

**1** Unscrew castle nut from ball joint of track rod. Then remove track rod by means of puller (36) from steering knuckle arm (24) (Fig. 1).

**2** Unbend tab on holder (21), unscrew hex. screws (20) and remove steering knuckle arm (Fig. 2).

**3** Loosen brake hose (7) on holder (5) from brake line (4) and remove from locking plate (Fig. 4).

For loosening and tightening brake lines, use **conventional special wrench only**.

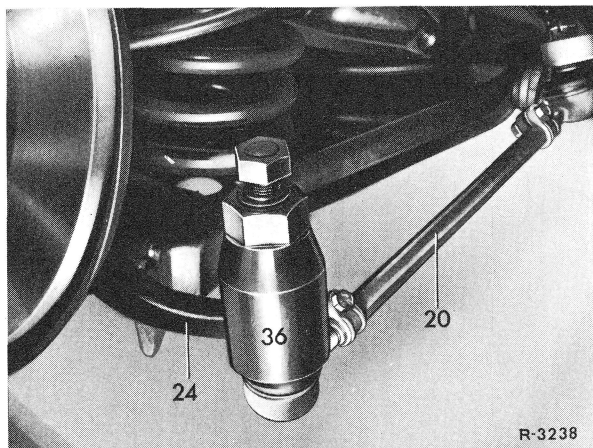

Fig. 1

20 Track rod

24 Steering knuckle arm

36 Puller

**Checkup**

**4** Steering knuckle arm cannot be checked with conventional shop means. **When in doubt**, in particular following an accident, install **a new steering knuckle arm**.

# 46.1 Removal and Installation of Steering Knuckle Arm

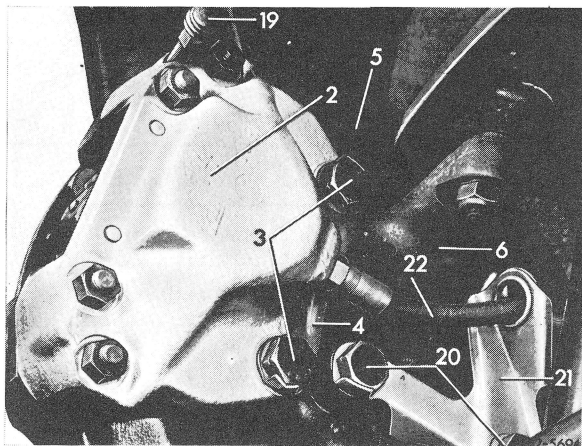

Fig. 2

- |                     |                                |
|---------------------|--------------------------------|
| 2 Caliper           | 19 Bleed screw with rubber cap |
| 3 Fitted hex. screw | 20 Hex. screw                  |
| 4 Locking plate     | 21 Holder                      |
| 5 Cover plate       | 22 Brake hose                  |
| 6 Steering knuckle  |                                |

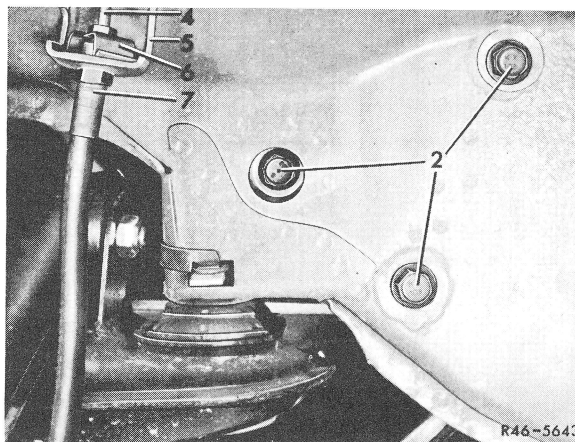

Fig. 4

- |                         |                     |
|-------------------------|---------------------|
| 2 Lock screw            | 6 Brake hose holder |
| 4 Brake line            | 7 Brake hose        |
| 5 Holder on side member |                     |

**6** Insert brake hose (22) through bore in holder (21) (Fig. 2).

**7** Attach brake hose (7) to brake line (4). Make sure that brake hose is installed in locking plate in holder (5) without wiping against any obstructions (Fig. 4).

**8** Attach track rod (20) to steering knuckle arm (24) with castle nut and insert cotter pins. Tightening torque 35 Nm (3.5 kpm) — reference value (Fig. 1).

**9** Bleed brakes (42.0–010).

**10** Check wheel adjusting values on front axle („Axles“ 40.1–320).

## Installation

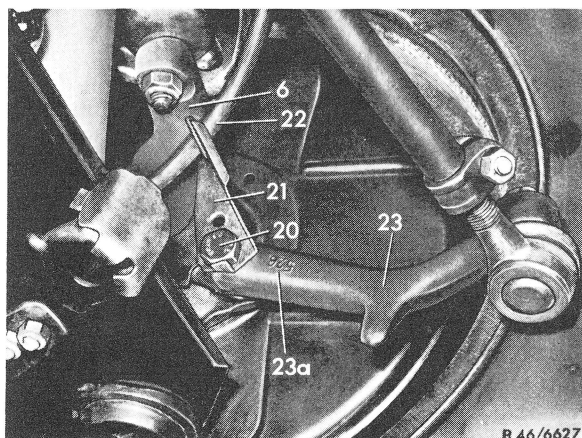

Fig. 3

- |                    |                                      |
|--------------------|--------------------------------------|
| 6 Steering knuckle | 22 Brake hose                        |
| 20 Hex. screw      | 23 Steering knuckle arm              |
| 21 Holder          | 23a Code No. on steering knuckle arm |

**5** Attach steering knuckle arm to steering knuckle (6) using a new holder (21). Tighten hex. screws (20) to specified torque of 80 Nm (8 kpm) and secure (Fig. 2 and 3).

When renewing steering knuckle arm, **make sure that correct lever identified by respective Code No.** is installed. Code No. is punched in laterally on lever.



Make two assembly sleeves according to dimensions shown in Fig. 7 to insert fastening rings (3) and (10). The flat wire clamping ring (3) will be very hard to install without using these assembly sleeves (Fig. 5).

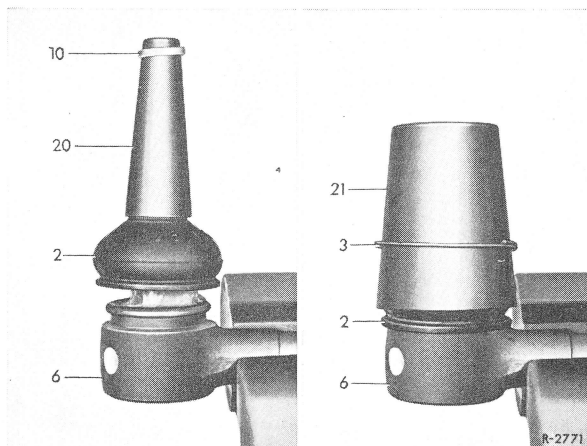

Fig. 6

- 2 Rubber sleeve
- 3 Flat wire clamping ring
- 6 Track rod end
- 10 Plastic fastening ring
- 20 Assembly sleeve for plastic ring
- 21 Assembly sleeve for flat wire clamping ring

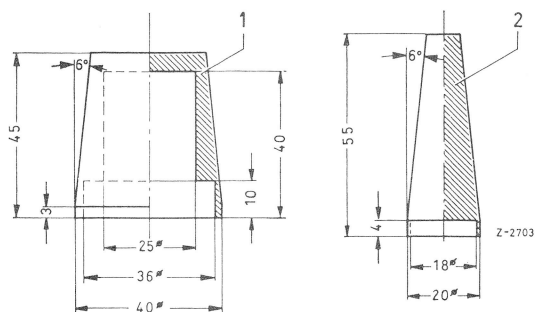

Fig. 7

- 1 Assembly sleeve for flat wire clamping ring
- 2 Assembly sleeve for plastic ring

**Note:** The two track rods and the drag link are provided with service-free joints, i. e., they are

provided with a grease charge for life. **On service-free joints** the **seal** against the penetration of dirt is of **decisive importance for the life of the joints**. A **damaged rubber sleeve should therefore be replaced immediately**, since otherwise the penetrating dirt will result in pertinent wear. For this reason, **the joints should be inspected carefully from time to time**.

### Installation

Mount track rods in such a manner that the track rod end with **left-hand threads** is **always at the left** (seen in driving direction).

**6** Clean ball pins as well as conical seats in steering arms perfectly from grease. Then push ball pins tightly into cone of steering arm and **screw on new-self-locking hex nut** and tighten (tightening torque 3.5 kpm – reference value).

**Caution!** Be sure to replace all self-locking hex nuts on principle.

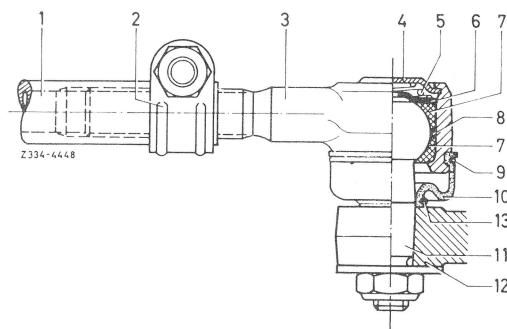

Fig. 8

- 1 Track rod pipe
- 2 Clamp
- 3 Track rod end
- 4 Closing cover
- 5 Compression spring
- 6 Pressure cup
- 7 Vulkollan bearing shell
- 8 Intermediate ring
- 9 Flat wire clamping ring
- 10 Rubber sleeve
- 11 Ball pin
- 12 Steering arm on steering knuckle

**7** Check toe-in (40.1–320)

